

S:\CIN\3700--3799\3731\006\Drawings\CAD\Civil_3d\SheetsPlan\LRC_GB_100.dwg 18-Jul-25 4:22 PM

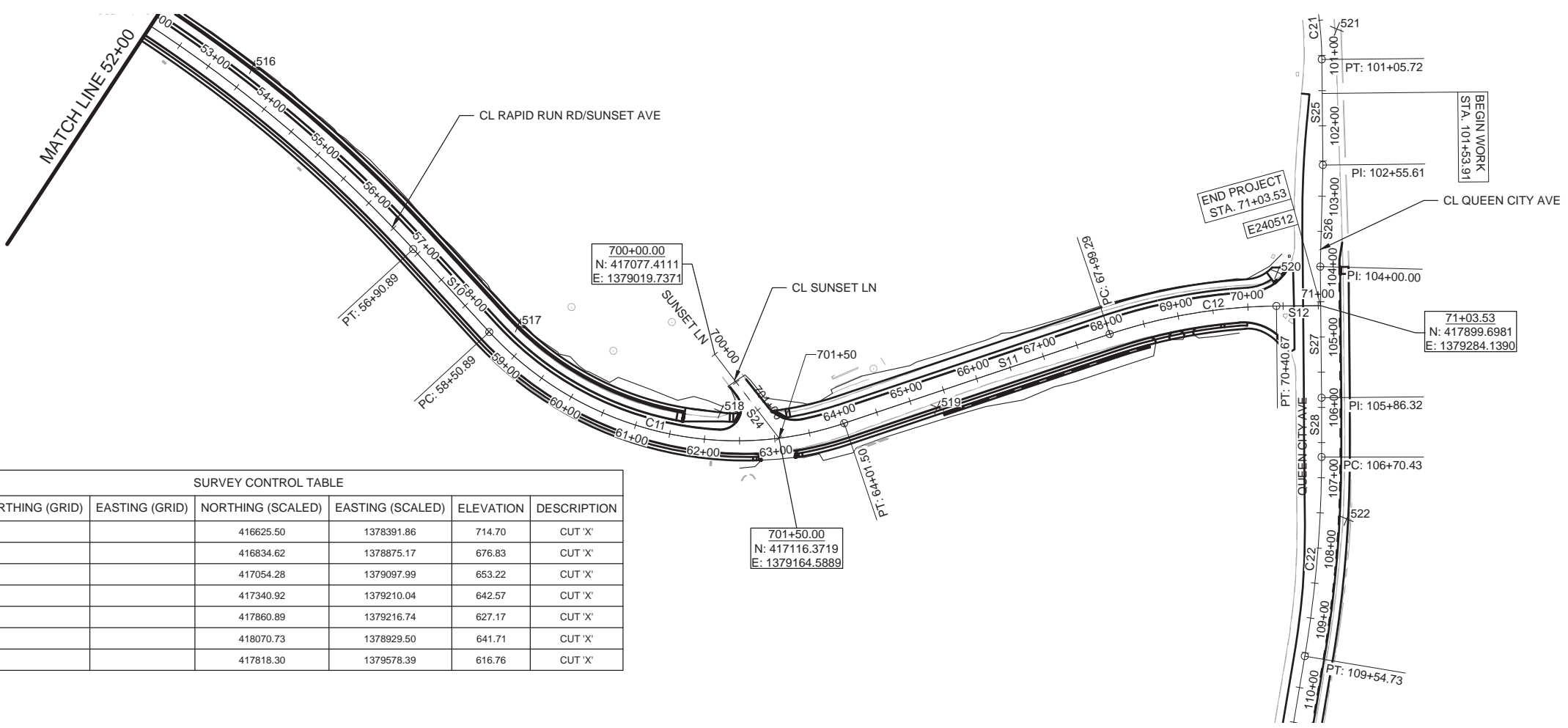

SURVEY CONTROL TABLE						
POINT #	NORTHING (GRID)	EASTING (GRID)	NORTHING (SCALED)	EASTING (SCALED)	ELEVATION	DESCRIPTION
516			416625.50	1378391.86	714.70	CUT 'X'
517			416834.62	1378875.17	676.83	CUT 'X'
518			417054.28	1379097.99	653.22	CUT 'X'
519			417340.92	1379210.04	642.57	CUT 'X'
520			417860.89	1379216.74	627.17	CUT 'X'
521			418070.73	1378929.50	641.71	CUT 'X'
522			417818.30	1379578.39	616.76	CUT 'X'

RAPID RUN RD/SUNSET AVE CL													
SEGMENT AND CURVE DATA													
REF. NO.	BEGIN	END	LENGTH	BEARING	P.I. STATION	P.I. NORTHING	P.I. EASTING	Δ	Dc	R	T	L	E
S1	0+00.00	3+42.13	342.13'	N32° 53' 37"E									
C1	3+42.13	7+10.10			5+29.06	412973.2901	1375465.9883	24°52'49"	6°45'42"	847.38'	186.93'	367.97'	20.37'
S2	7+10.10	8+11.34	101.24'	N57° 46' 26"E									
C2	8+11.34	12+43.79			10+29.29	413243.1874	1375894.1443	17°39'42"	4°05'02"	1402.93'	217.96'	432.46'	16.83'
S3	12+43.79	13+63.30	119.51'	N40° 06' 44"E									
C3	13+63.30	16+58.28			15+11.55	413614.6573	1376207.0867	14°12'15"	4°48'55"	1189.87'	148.25'	294.98'	9.20'
S4	16+58.28	21+33.59	475.30'	N54° 18' 59"E									
C4	21+33.59	25+06.17			23+20.98	414087.6913	1376865.7810	15°14'53"	4°05'33"	1400.00'	187.40'	372.58'	12.49'
C5	25+06.17	29+31.24			27+21.90	414400.6762	1377119.8506	24°06'00"	5°40'10"	1010.60'	215.73'	425.08'	22.77'
S5	29+31.24	33+06.61	375.36'	N14° 58' 07"E									
S6	33+06.61	34+19.22	112.62'	N14° 57' 41"E									
C6	34+19.22	36+33.54			35+26.43	415184.0830	1377329.2740	4°18'53"	2°00'48"	2845.86'	107.21'	214.31'	2.02'
C7	36+33.54	37+65.56			36+99.60	415347.6358	1377386.4728	5°18'42"	4°01'24"	1424.12'	66.06'	132.02'	1.53'
C8	37+65.56	38+60.18			38+12.91	415450.7643	1377433.6620	5°54'07"	6°14'14"	918.60'	47.35'	94.62'	1.22'
S7	38+60.18	40+60.40	200.22'	N18° 41' 09"E									
S8	40+60.40	41+24.68	64.28'	N51° 36' 45"E									
C9	41+24.68	41+78.31			41+51.69	415741.9750	1377584.5326	16°45'54"	31°15'51"	183.26'	27.01'	53.62'	1.98'
S9	41+78.31	44+69.82	291.52'	N34° 50' 51"E									
C10	44+69.82	56+90.89			51+00.03	416520.5726	1378126.6294	34°57'28"	2°51'46"	2001.34'	630.21'	1221.07'	96.88'
S10	56+90.89	58+50.89	160.00'	N69° 48' 19"E									
C11	58+50.89	64+01.50			61+61.25	416900.5016	1379159.5344	65°57'15"	11°58'42"	478.33'	310.36'	550.61'	91.86'
S11	64+01.50	67+99.29	397.78'	N3° 51' 04"E									
C12	67+99.29	70+40.67			69+20.99	417728.4723	1379215.2685	18°03'36"	7°28'54"	765.81'	121.70'	241.39'	9.61'
S12	70+40.67	71+03.53	62.85'	N21° 54' 40"E									

SUNSET LN CL													
SEGMENT AND CURVE DATA													
REF. NO.	BEGIN	END	LENGTH	BEARING	P.I. STATION	P.I. NORTHING	P.I. EASTING	Δ	Dc	R	T	L	E
S24	700+00.00	701+50.00	150.00'	N74° 56' 44"E									





HORIZONTAL SCALE IN FEET

CALCULATED
EME
CHECKED
JCH

SCHEMATIC PLAN
SUNSET AVE

LICK RUN CONNECTOR

3
219



CALCULATED
E.M.E.
CHECKED
JCH

SCHEMATIC PLAN
QUEEN CITY AVE

LICK RUN CONNECTOR

S:\CIN\3700--3799\3731\006\Drawings\CAD\Civil_3d\SheetsPlan\LRC_GB_100.dwg 18-Jul-25 4:22 PM

SURVEY CONTROL TABLE						
POINT #	NORTHING (GRID)	EASTING (GRID)	NORTHING (SCALED)	EASTING (SCALED)	ELEVATION	DESCRIPTION
520			417860.89	1379216.74	627.17	CUT 'X'
521			418070.73	1378929.50	641.71	CUT 'X'
522			417818.30	1379578.39	616.76	CUT 'X'
523			417556.97	1380026.32	603.00	CUT 'X'
524			417411.28	1380378.74	593.31	CUT 'X'
525			417521.15	1380810.93	583.07	CUT 'X'
526			417640.05	1381174.67	573.78	CUT 'X'

TILLIE AVE CL													
SEGMENT AND CURVE DATA													
REF. NO.	BEGIN	END	LENGTH	BEARING	P.I. STATION	P.I. NORTHING	P.I. EASTING	Δ	Dc	R	T	L	E
S37	800+00.00	801+00.00	100.00'	S4° 09' 22"W									

QUEEN CITY AVE CL													
SEGMENT AND CURVE DATA													
REF. NO.	BEGIN	END	LENGTH	BEARING	P.I. STATION	P.I. NORTHING	P.I. EASTING	Δ	Dc	R	T	L	E
C21	100+00.00	101+05.72			100+53.06	418054.3768	1378912.2345	12°06'53"	11°27'33"	500.00'	53.06'	105.72'	2.81'
S25	101+05.72	102+55.61	149.88'	S68° 07' 42"E									
S26	102+55.61	104+00.00	144.39'	S66° 08' 38"E									
S27	104+00.00	105+86.32	186.32'	S68° 07' 42"E									
S28	105+86.32	106+70.43	84.11'	S67° 32' 12"E									
C22	106+70.43	109+54.73			108+12.91	417764.3892	1379614.9304	9°31'33"	3°21'02"	1710.00'	142.48'	284.30'	5.93'
S29	109+54.73	111+87.02	232.29'	S58° 00' 39"E									
C23	111+87.02	116+13.00			114+05.06	417450.3430	1380117.7203	30°07'57"	7°04'25"	810.00'	218.04'	425.99'	28.83'
S30	116+13.00	116+64.34	51.33'	S88° 08' 36"E									
C24	116+64.34	119+97.00			118+32.39	417436.1711	1380554.9187	20°03'48"	6°01'52"	950.00'	168.05'	332.66'	14.75'
S31	119+97.00	123+06.78	309.78'	N71° 47' 36"E									
S32	123+06.78	124+06.78	100.00'	N71° 21' 47"E									
C25	124+06.78	131+62.02			127+98.91	417742.7392	1381475.1510	38°02'31"	5°02'13"	1137.49'	392.13'	755.24'	65.69'
S33	131+62.02	132+92.56	130.54'	S70° 35' 43"E									
S34	132+92.56	140+55.64	763.08'	S70° 22' 10"E									
S35	140+55.64	143+06.07	250.43'	S70° 56' 49"E									

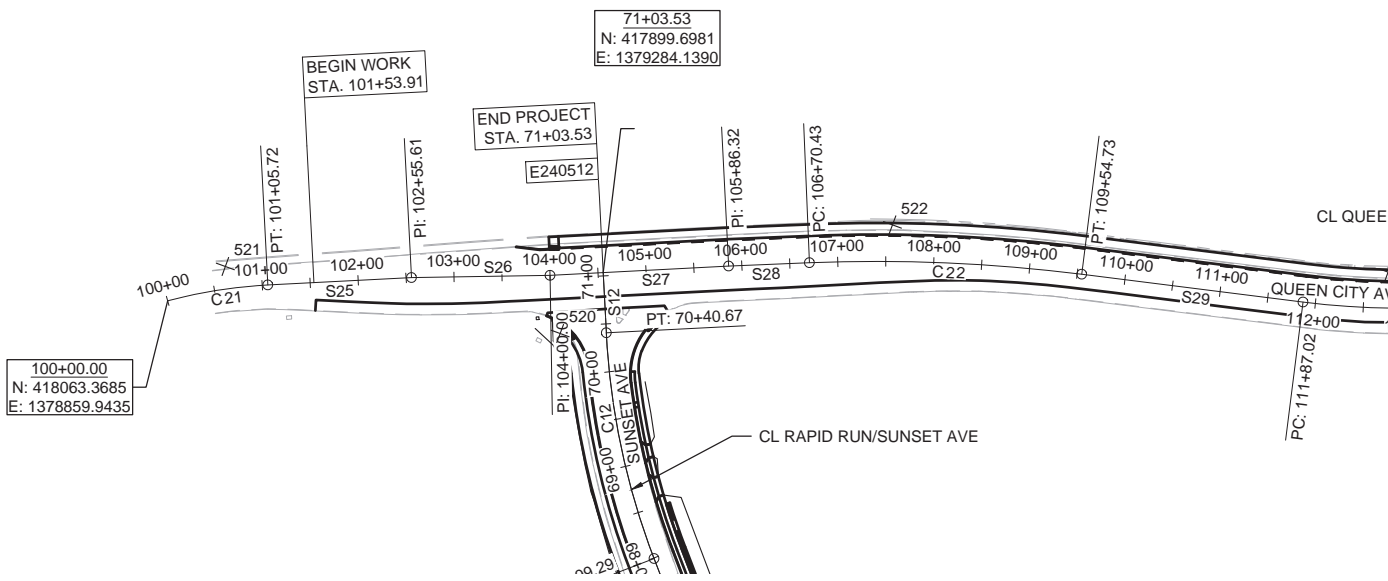

SURVEY CONTROL TABLE						
POINT #	NORTHING (GRID)	EASTING (GRID)	NORTHING (SCALED)	EASTING (SCALED)	ELEVATION	DESCRIPTION
527			417716.43	1381512.97	565.15	CUT 'X'
528			417618.96	1381833.25	556.86	CUT 'X'
529			417573.82	1382075.59	550.38	CUT 'X'
530			417502.78	1382422.78	541.75	CUT 'X'
531			417368.48	1382647.50	535.82	CUT 'X'
532			417204.46	1382972.50	529.32	CUT 'X'
533			417152.87	1383103.30	526.54	CUT 'X'



0 100 200
HORIZONTAL
SCALE IN FEET